

Fuel Monitor

The 3L Filters™ fuel monitors provide clean, dry fuel in aviation fueling systems. An increase in differential pressure across the unit or a corresponding decrease in flow rate indicates water and/or dirt is present in the influent fuel.

Applications

Final point of filtration in aviation fuelling systems.

Standard Features

- designed to ASME Section VIII Div.1 & 2
- 150 psig standard design pressure
- -20°F to 160°F (-29°C to 71°C) standard design temperature
- 150 lb ANSI RF flanged inlet/outlet
- 600 lb NPT couplings for vent, drain pressure gauge and air eliminator connections
- victaulic connections for quick uncoupling
- aluminum housing material
- horizontal housings
- quick access for replacement of cartridges
- standard Swing Bolt closure with O-ring seal
- saddle supports

Options & Accessories

- custom design pressures to 2500 psig
- custom flange ratings
- custom housing materials
- vertical housings in carbon or stainless steel
- optional closure: Thru-Bolt
- O-ring closure seal in Buna or Viton®
- internal epoxy coating on carbon steel models
- electropolishing of stainless steel housings
- passivation of stainless steel housings
- paint or coating to customer specifications
- additional nozzles as needed
- air eliminator
- valves
- safety relief valves
- pressure gauges
- sampling kit



Model Coding

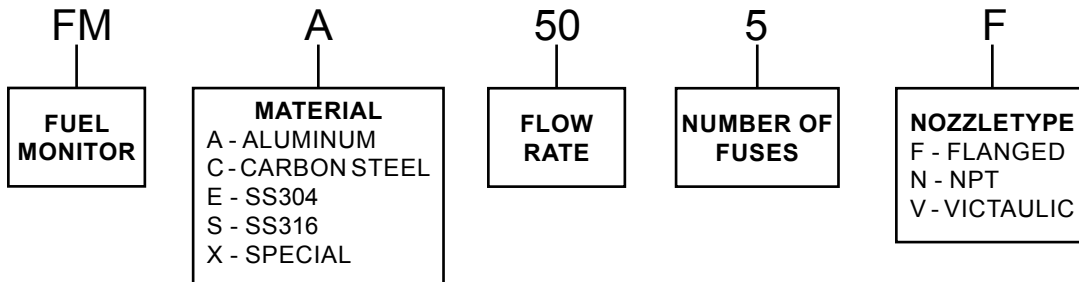

Fuel Monitor

Fig.	Model No.	Separator Elements		Vessel OD A in (mm)	B1 in (mm)	B2 in (mm)	C in (mm)	D in (mm)	E in (mm)	H in (mm)	Inlet/ Outlet (RF)	Vent Safety Drains (NPT)	Press. Gauge (NPT)	GPM (US) Light Fluids	Weight lbs (kg)
		Qty	Lg in (mm)												
1	FMA505F	5	10.8125 (275)	6.625 (168)	14.00 (356)	6.250 (159)	11.5 (292)	18.75 (476)	28 (711)	6.875 (175)	2"	3/4"	1/2"	50	40 (18.1)
1	FMA1005F	5	20.8125 (529)	6.625 (168)	23.25 (591)	6.250 (159)	11.5 (292)	29.75 (756)	49 (1245)	15.000 (381)	2"	3/4"	1/2"	100	45 (20.4)
1	FMA1505F	5	30.8125 (783)	6.625 (168)	33.00 (838)	6.250 (159)	11.5 (292)	40.50 (1029)	70 (1778)	25.000 (635)	2"	3/4"	1/2"	150	50 (22.7)
1	FMA20020F	20	10.8125 (275)	12.750 (324)	28.50 (724)	9.375 (238)	18.0 (457)	38.25 (978)	47 (1194)	20.000 (508)	4"	3/4"	1/2"	200	110 (49.9)
1	FMA20010F	10	20.8125 (529)	10.750 (273)	10.00 (254)	9.375 (238)	17.0 (432)	41.00 (1041)	60 (1524)	25.000 (635)	4"	3/4"	1/2"	200	155 (70.3)
1	FMA30020F	20	15.8125 (402)	12.750 (324)	14.00 (356)	9.375 (238)	18.0 (457)	43.25 (1099)	57 (1448)	25.000 (635)	4"	3/4"	1/2"	300	130 (60.0)
1	FMA30010F	10	30.8125 (783)	10.750 (273)	10.00 (254)	9.375 (238)	17.0 (432)	51.00 (1295)	80 (2032)	30.000 (762)	4"	3/4"	1/2"	300	165 (74.8)
1	FMA40020F	20	20.8125 (529)	12.750 (324)	14.00 (356)	9.375 (238)	18.0 (457)	48.25 (1226)	67 (1702)	30.000 (762)	4"	3/4"	1/2"	400	155 (70.3)
1	FMA50020F	20	25.8125 (6569)	12.750 (324)	14.00 (356)	9.375 (238)	18.0 (457)	53.25 (1353)	77 (1956)	35.000 (889)	6"	3/4"	1/2"	500	175 (79.4)
1	FMA60020F	20	30.8125 (783)	12.750 (324)	14.00 (356)	9.375 (238)	18.0 (457)	58.25 (1480)	87 (2210)	40.000 (1016)	6"	3/4"	1/2"	600	200 (90.7)
1	FMA80027F	27	30.8125 (783)	14.000 (356)	25.00 (635)	10.500 (267)	20.0 (508)	51.50 (1308)	80 (2032)	35.000 (889)	6"	3/4"	1/2"	800	170 (77.1)
1	FMA100034F	34	30.8125 (783)	16.000 (406)	25.00 (635)	11.500 (292)	22.5 (572)	57.75 (1467)	86 (2184)	40.000 (1016)	6"	3/4"	1/2"	1000	200 (90.7)
1	FMA120040F	40	30.8125 (783)	18.250 (457)	25.00 (635)	15.125 (384)	27.5 (699)	57.75 (1467)	86 (2184)	40.000 (1016)	6"	3/4"	1/2"	1200	290 (131.5)

Note:

Dimension 'E' is the minimum clearance required for cartridge removal.
Flow rates based on kerosene.
Drawings for reference only. Certified drawings will be supplied after receipt of order.

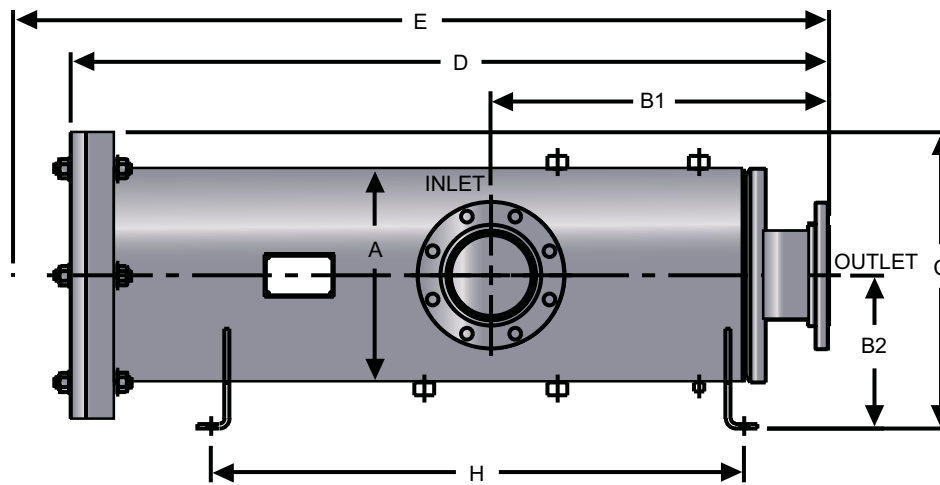

Figure 1 Fuel Monitor

Fuel Monitor