

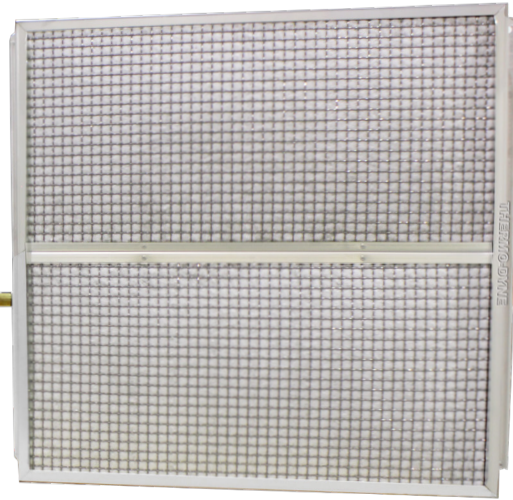

PRODUCT DATASHEET

# EnviroDyne™

## METHANE DESTRUCTION UNIT



### OVERVIEW

The reduction of methane emissions is crucial and has become a global concern. Methane is the main component of natural gas and a significant source of greenhouse gas, 80 times more potent than CO<sub>2</sub>. Thermon's Methane Destruction Unit targets the flameless conversion of methane to carbon dioxide and water vapor.

Thermon has been a global leader in catalytic heating technologies for use in hazardous locations for over 50 years.

### HOW IT WORKS

Thermon's patent pending Methane Destruction Unit is designed for continuous use and only requires temporary electric power (often via a battery) for initial start-up. The unit is designed to operate indefinitely once started and contains no moving parts. Our expertise in catalytic reactions has been used to develop special catalyst formulations specifically targeting the flameless conversion of methane to carbon dioxide and water vapor.

The Thermon EnviroDyne™ unit consists of two modules. One is the converter module and the other is the gas train module.

### WHERE IT IS USED

The Thermon EnviroDyne™ Methane Destruction Unit is intended for use with vented emissions from pneumatic devices such as chemical injection pumps, control valves, compressor seals, and other emissions venting applications.

### FEATURES & BENEFITS

- Industry leading design provides the highest reliability.
- Patent pending proprietary explosion proof catalyst pad.
- Catalytic reaction does not produce harmful NO<sub>x</sub>.
- Specifically designed for high efficiency flameless conversion of methane.
- Converter is constructed of 300 series stainless-steel components for corrosion resistance.
- Contains no moving parts and is designed to operate indefinitely when supplied with air and clean fuel.
- Heat is generated as a by-product of the conversion, which is an added benefit for freeze protection and comfort heating in Northern climates.
- Does not require any power source to operate once started.
- Suitable for use in hazardous locations Class I, Div 1 & 2, Group D locations, T2C Temp. Code.
- Supplied with necessary pressure regulators, valves, and piping.
- Explosion proof junction box for electric connection.
- Available for voltages 12VDC, 120, 208, 240 & 480VAC & 600 VAC.
- Standard NPT gas connections.
- Several sizes available.
- Scalable design.



PRODUCT DATASHEET

# EnviroDyne™

## METHANE DESTRUCTION UNIT

Thermon's patent pending Methane Destruction Unit is designed for continuous use and only requires electric power for initial start-up. The unit is designed to operate indefinitely once started and contains no moving parts.

### METHANE DESTRUCTION UNIT DATA

CATALOG NO.	HIGH EFFICIENCY (90%)					
	MDH101	MDH201	MDH202	MDH303	MDH402	MDH404
NO. OF CONVERTORS	1	1	2	3	2	4
CONVERTOR SIZE	12X24	24X24	12X24	12X24	24X24	12X24
MAX. INPUT	10,000 BTU/HR	20,000 BTU/HR	20,000 BTU/HR	30,000 BTU/HR	40,000 BTU/HR	40,000 BTU/HR
SCFH	10	20	20	30	40	40
MIN. GAS PRESSURE	7" WC	7" WC	7" WC	7" WC	7" WC	7" WC
CONVERTOR MODULE DIMENSIONS	A	24	24	24	36	48
	B	12	24	24	24	24
GAS TRAIN MODULE DIMENSIONS	C	4	4	4	4	4
	D	32	32	32	32	32
STARTUP VOLTAGE	E	24	24	24	24	24
	F	14	14	14	14	14
STARTUP WATTAGE PER CONVERTOR	12VDC, 120, 208, 240, 480 OR 600 VAC 360W AT 12 VDC 500W AT 120, 208, 240 VAC 720W AT 480 VAC 540W AT 600 VAC					

### PRODUCT DIMENSIONS

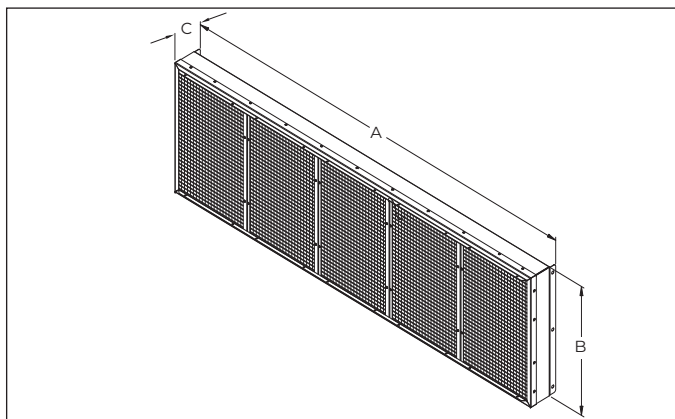

Converter Module

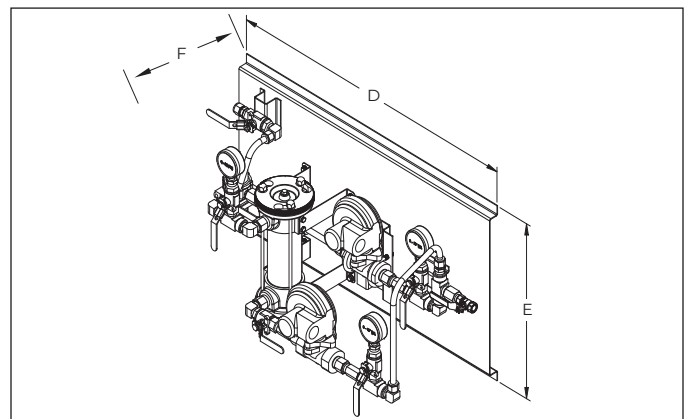

Gas Train Module

### OPTIONAL FEATURES

- Protective wire guard
- Custom sizes available
- Optional voltages
- Vent Hood

### CERTIFICATION & COMPLIANCE

CSA C/US certified to meet both Canada and USA requirements for use in Class I, Div. 1 & 2 hazardous