

ET-DC (OJ)
ET-FC (FOJ)
End Termination Kit
INSTALLATION PROCEDURES

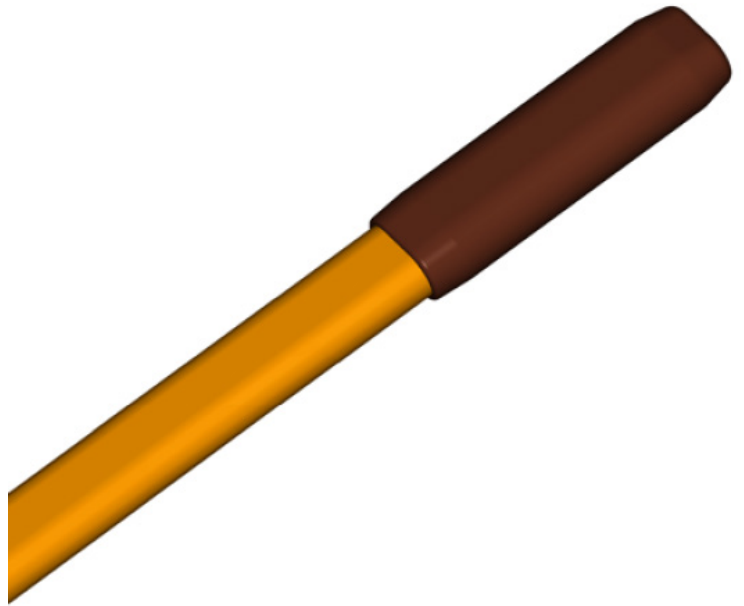

End Circuit Termination of DLX and DSX
Self-Regulating Heat Tracing



ET-DC and ET-FC End Termination Kits

The ET-DC (OJ) and ET-FC (FOJ) Kits are used for end circuit termination of DLX self-regulating heat tracing.

Receiving, Storing and Handling

1. Inspect materials for damage incurred during shipping.
2. Report damages to the carrier for settlement.
3. Identify parts against the packing list to ensure the proper type and quantity has been received.
4. Store in a dry location.

Kit Contents

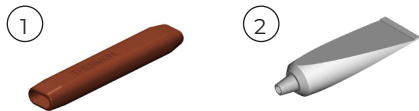

Item	Quantity	Description
1	1	End Cap (Either ET-D for OJ or ET-F for FOJ)
2	2	RTV Tube

INSTALLATION PROCEDURES

Warnings

- Due to the risk of electrical shock, arcing and fire caused by product damage or improper usage, installation or maintenance, a ground-fault protection device is required.
- Installation must comply with Thermon requirements and be installed in accordance with the NEC, CEC, or any other applicable national and local codes.
- Component approvals and performance ratings are based on the use of Thermon specified parts only.
- Keep ends of heating cable and kit components dry before and during installation.

Certifications/Approvals



Tools Required

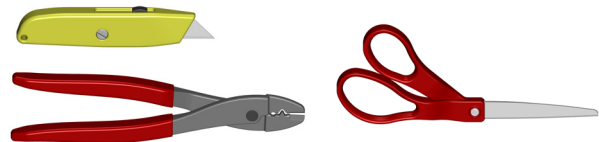

Installation Instructions for DLX and DSX

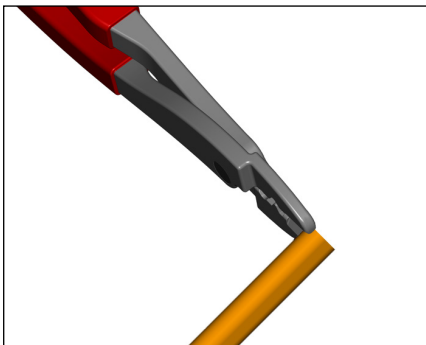

1. Cut off end of cable.

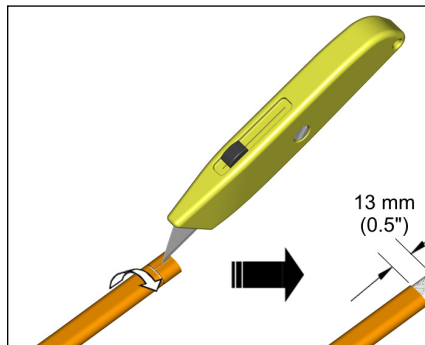

2. Cut and remove overjacket.

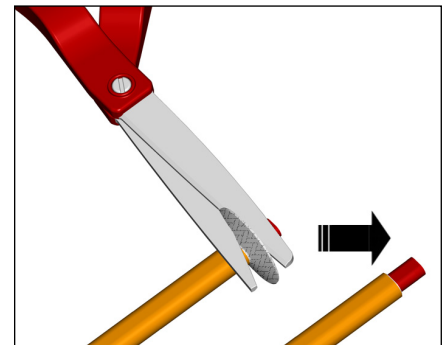

3. Trim away exposed braid from cable.

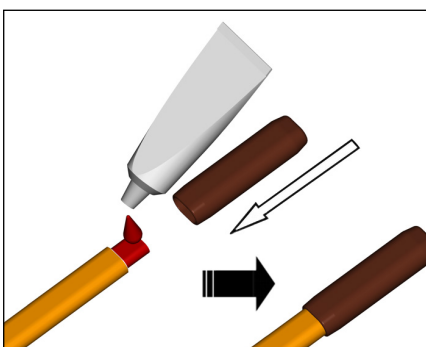

4. Fill the end cap with RTV sealant and apply a circumferential bead to cable [minimum of 3 mm (0.12") wide]. Slide end cap onto end of cable.

Cable Take-off for DLX and DSX

